

Authors: Jane Kubala and Bronwyn Struthers

Watercare's New Multi-purpose Training Facility – Enhancing Training Across the Construction Industry



water
NEW ZEALAND
CONFERENCE & EXPO
17-19 OCTOBER 2023
Tākina, Te Whanganui-a-Tara Wellington

Purpose



The Central Interceptor Project

- Large projects such as Watercare's Central Interceptor Project provide the opportunity to elevate health, safety and well-being standard across the industry.
- 'Good to great' programme of initiatives implemented to a large workforce over a 6-year construction period.
- Invested in a training facility to ensure a legacy for the Project.



Watercare's Role

- Watercare plans to invest \$18.5billion on infrastructure in the next 20 years.
- Watercare's role as a large client provides the opportunities to lead the way in encouraging and influencing positive change and improvement to health, safety and wellbeing outcomes across the construction industry.



Design and Construction

- Collaboration with different industry groups led to the success of the facility.

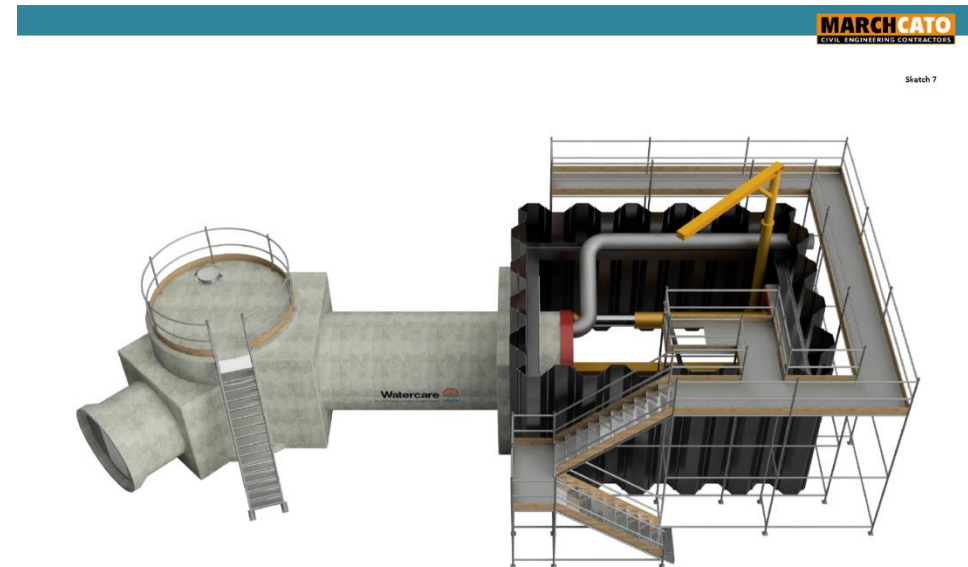
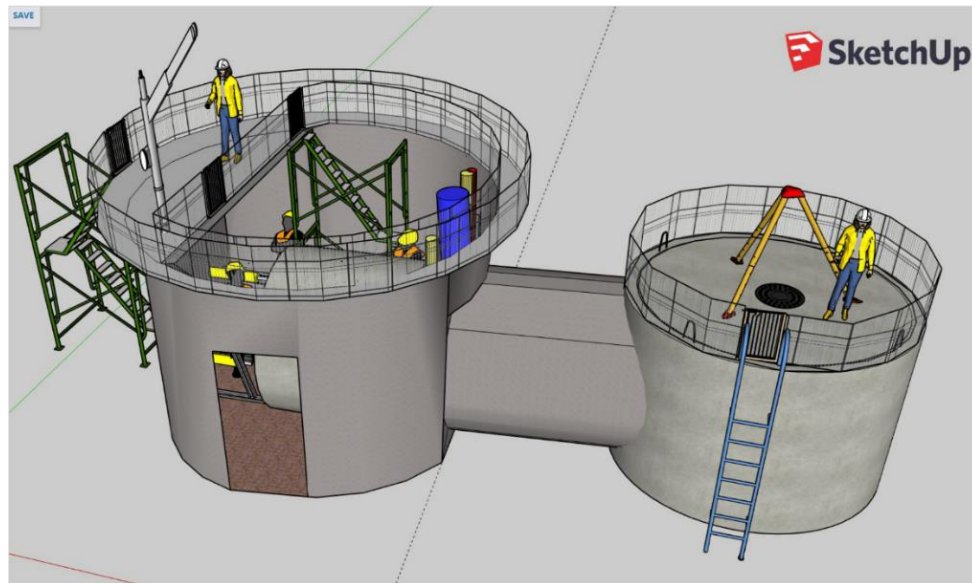



Facility in Operation

- Open for the construction industry to use for a large variety of training courses.
- Watercare focused trainings
- Developed Watercare's Training Campus



Benefit Realisation



Positive feedback received from organisations and workers



The facility has provided the opportunity to make health and safety training effective while being safe.

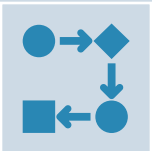

Ongoing improvements are being implemented.



Aspirations

- Aim to inspire the development of future facilities by different organisations.
- Ongoing developments within this facility

